

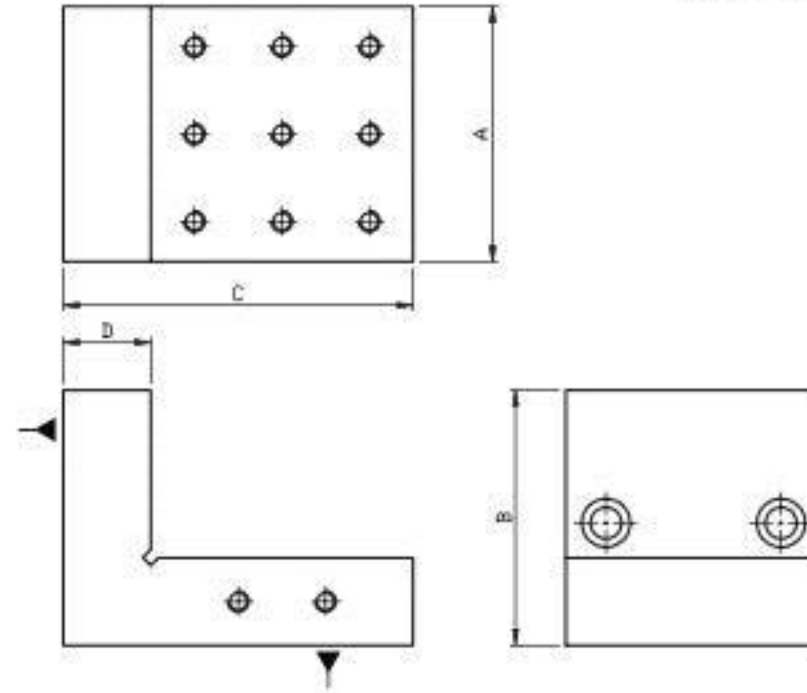

# Precision Steel Angle Plate

HIGH PRECISION TYPE



MATERIAL : YK30 ALLOY STEEL

ACCURACY : 0.005/100MM

HARDEN TREATMENT UP TO HRC 58°

※ Not for LAB

ORDER NO.	A	B	C	D	N.W (KGS)	CODE NO.
<b>VRS-33</b>	3" 75	3" 75	4" 100	1" 25	2.2	2006-060
<b>VRS-44</b>	4" 100	4" 100	4" 100	1" 25	3.7	2006-061
<b>VRS-46</b>	4" 100	4" 100	6" 150	1" 25	4.5	2006-062
<b>VRS-85</b>	8" 200	120	8" 200	40	14.3	2006-063
<b>VRS-1206</b>	12" 300	6" 150	12" 300	2" 50	32.3	2006-064