

V-BLOCK SETS

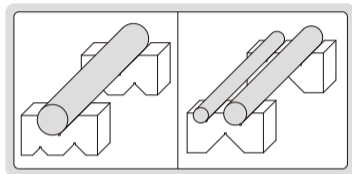

6887-3

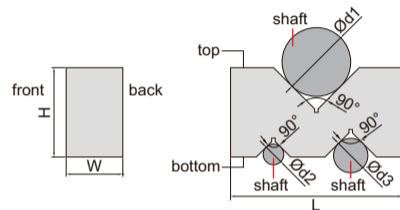

- Two V-blocks per set
- Made of hardened tool steel

Code	Size (LxWxH)	Range of shafts ($\varnothing d1$)	Range of shafts ($\varnothing d2$)	Range of shafts ($\varnothing d3$)
6887-1	50x19x24mm	3-32mm	3-16mm	3-22mm
6887-2	75x24x35mm	3-50mm	3-20mm	3-32mm
6887-3	100x33x52mm	3-68mm	3-26mm	3-40mm
6887-4	125x44x69mm	3-87mm	3-34mm	3-50mm

Code	Parallelism of three V grooves to top and bottom sides	Height difference of a matched pair
6887-1	5 μ m	5 μ m
6887-2	5 μ m	5 μ m
6887-3	5 μ m	5 μ m
6887-4	5 μ m	5 μ m