

ELM

Lifting Magnet

The manually switchable permanent lifting magnet is a very good solution for moving all ferromagnetic materials (ferrous materials) in an efficient, fast, safe and economic way.

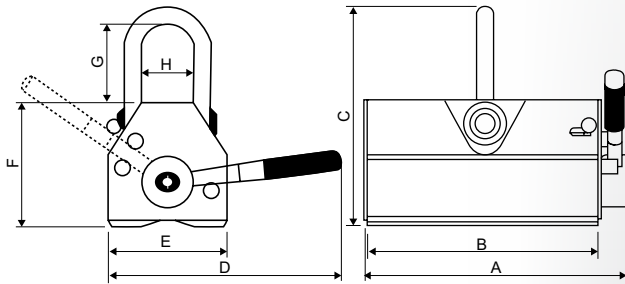

Application

- ▶ For flat and round material, as the magnetic adhesive surface is provided with a prism pole shoe.
- ▶ For thin and thick sheets depending on the magnet size
- ▶ For raw material, semi-finished and finished products
- ▶ In mechanical engineering, tool manufacturing, plant engineering, steel construction, shipbuilding, transport company or materials store

Features

- Ⓞ Smooth two-hand operation via hand lever and safety locking
- Ⓞ Max. operation temperature 80°C
- Ⓞ Absolutely safe lifting, as the recommended lifting force is secured 3 times (the pull-off strength is 3 times of the recommended lifting force)
- Ⓞ Use of durable and extremely strong Neodym magnet materials
- Ⓞ Compact, sturdy construction, low dead weight

Options

- Ⓞ Services: Test according to German Accident Prevention Regulations and repair

Technical data

	Dimensions [mm]							■ Load		● Load		Weight [kg]	No.	
	A	B	C	D	E	F	G	SWL 3:1 Fh [kg]	Min. thickness [mm]	SWL 3:1 Fh [kg]	Max. ø [mm]			Max. length [mm]
ELM 100	107	84	120	125	60	71	41	100	15	45	150	1,000	2.5	41616
ELM 300	180	155	156	185	90	93	51	300	25	135	250	1,500	8.6	41617
ELM 600	255	224	212	260	115	120	77	600	30	270	350	2,000	21.0	41618
ELM 1000	280	245	286	371	165	169	97	1,000	40	450	450	2,500	46.0	41619
ELM 2000	422	380	348	512	216	215	105	2,000	55	900	550	3,000	118.0	27979