

Tapers

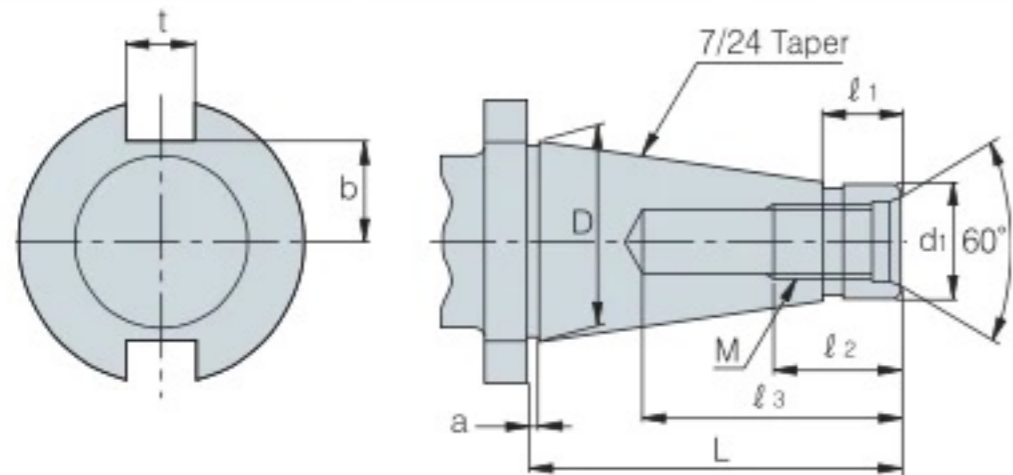

Standard taper of american milling machine



NT No.	Dimensions	D	D ₁	L	l ₁	M	l ₂	l ₃	a	t	b
30	1 ¹ / ₄	31.750	17.40 ^{-0.29} _{0.36}	70	20	UNC 1/2"	24	50	1.6	15.9	6
40	1 ³ / ₄	44.450	25.32 ^{-0.30} _{0.384}	95	25	UNC 5/8"	30	60	1.6	15.9	22.5
50	2 ³ / ₄	69.850	39.60 ^{-0.31} _{0.41}	130	25	UNC 1"	45	90	3.2	25.4	35
60	4 ¹ / ₄	107.950	60.20 ^{-0.34} _{0.46}	210	45	UNC 1 1/4"	56	110	3.2	25.4	60

(mm)