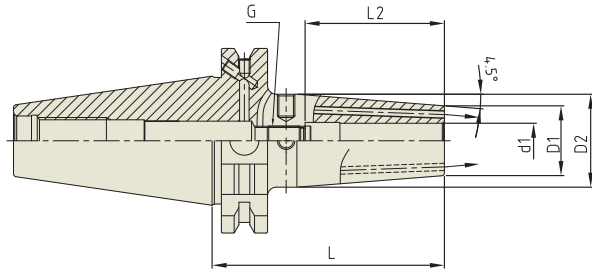

**SHRINK FIT HOLDER (Coolant Channel)**
**SFHC**

Unit : mm

TAPER No.	MODEL No.	EDP No.	d1	D1	D2	L	L2	G	WEIGHT (Kg)
40	SK40AD/B-SFH6C-80	P2801301C	6	21	27	80	36	M5x0.8	1.10
	SK40AD/B-SFH6C-120	P2771368C	6	21	27	120	36	M5x0.8	1.15
	SK40AD/B-SFH6C-160	P2801302C	6	21	27	160	36	M5x0.8	1.15
	SK40AD/B-SFH8C-80	P2801303C	8	21	27	80	36	M6x1.0	1.11
	SK40AD/B-SFH8C-120	P2771369C	8	21	27	120	36	M6x1.0	-
	SK40AD/B-SFH8C-160	P2801304C	8	21	27	160	36	M6x1.0	1.15
	SK40AD/B-SFH10C-80	P2801305C	10	24	32	80	42	M8x1.0	1.10
	SK40AD/B-SFH10C-120	P2771362C	10	24	32	120	42	M8x1.0	-
	SK40AD/B-SFH10C-160	P2801306C	10	24	32	160	42	M8x1.0	1.15
	SK40AD/B-SFH12C-80	P2801307C	12	24	32	80	47	M10x1.0	1.10
	SK40AD/B-SFH12C-120	P2771363C	12	24	32	120	47	M10x1.0	-
	SK40AD/B-SFH12C-160	P2801308C	12	24	32	160	47	M10x1.0	1.15
	SK40AD/B-SFH16C-80	P2801311C	16	27	34	80	50	M12x1.0	1.20
	SK40AD/B-SFH16C-120	P2771364C	16	27	34	120	50	M12x1.0	-
	SK40AD/B-SFH16C-160	P2801312C	16	27	34	160	50	M12x1.0	1.50
	SK40AD/B-SFH20C-80	P2801315C	20	33	42	80	52	M16x1.0	1.40
	SK40AD/B-SFH20C-120	P2771365C	20	33	42	120	52	M16x1.0	1.40
	SK40AD/B-SFH20C-160	P2801316C	20	33	42	160	52	M16x1.0	1.70
	SK40AD/B-SFH25C-90	P2801317C	25	44	53	90	58	M16x1.0	1.70
	SK40AD/B-SFH25C-100	P2771366C	25	44	53	100	58	M16x1.0	-
SK40AD/B-SFH25C-160	P2801318C	25	44	53	160	58	M16x1.0	-	
SK40AD/B-SFH32C-100	P2771367C	32	44	53	100	63	M16x1.0	-	

- ▶ Supplied without balancing screw.
- ▶ Balancing grade G2.5 at 25,000 RPM or U max <1 gmm.
- ▶ With two coolant channel bores.
- ▶ Resealable coolant channel type is available upon request.  
(Thread for plugging screws & 2 screws)

▶ NEXT PAGE

# SHRINK FIT HOLDER (Coolant Channel) SFHC

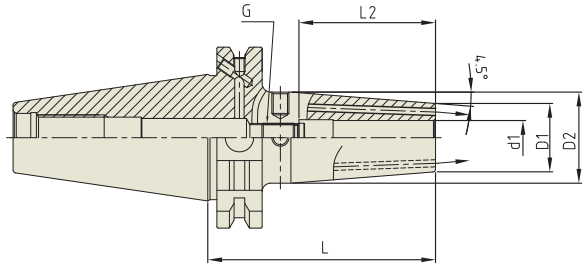

Unit : mm									
TAPER No.	MODEL No.	EDP No.	d1	D1	D2	L	L2	G	WEIGHT (Kg)
50	SK50AD/B-SFH6C-80	P2801319C	6	21	27	80	36	M5x0.8	1.50
	SK50AD/B-SFH6C-160	P2801320C	6	21	27	160	36	M5x0.8	2.00
	SK50AD/B-SFH8C-80	P2801321C	8	21	27	80	36	M6x1.0	1.50
	SK50AD/B-SFH8C-160	P2801322C	8	21	27	160	36	M6x1.0	2.00
	SK50AD/B-SFH10C-80	P2801323C	10	24	32	80	42	M8x1.0	1.50
	SK50AD/B-SFH10C-160	P2801324C	10	24	32	160	42	M8x1.0	2.00
	SK50AD/B-SFH12C-80	P2801325C	12	24	32	80	47	M10x1.0	1.60
	SK50AD/B-SFH12C-160	P2801326C	12	24	32	160	47	M10x1.0	2.10
	SK50AD/B-SFH16C-80	P2801329C	16	27	34	80	50	M12x1.0	1.60
	SK50AD/B-SFH16C-160	P2801330C	16	27	34	160	50	M12x1.0	2.10
	SK50AD/B-SFH20C-80	P2801333C	20	33	42	80	52	M16x1.0	1.80
	SK50AD/B-SFH20C-160	P2801334C	20	33	42	160	52	M16x1.0	2.20
	SK50AD/B-SFH25C-90	P2801335C	25	44	53	90	58	M16x1.0	2.00
SK50AD/B-SFH25C-160	P2801336C	25	44	53	160	58	M16x1.0	2.40	

- ▶ Supplied without balancing screw.
- ▶ Balancing grade G2.5 at 25,000 RPM or U max <1 gmm.
- ▶ With two coolant channel bores.
- ▶ Resealable coolant channel type is available upon request.  
(Thread for plugging screws & 2 screws)