

ER COLLET CHUCK

STRAIGHT-K

FRÄSERSPANNFUTTER - ER
MANDRIN À PINCES - ER
MANDRINO PORTA PINZE - ER
PORTAPINZAS - ER

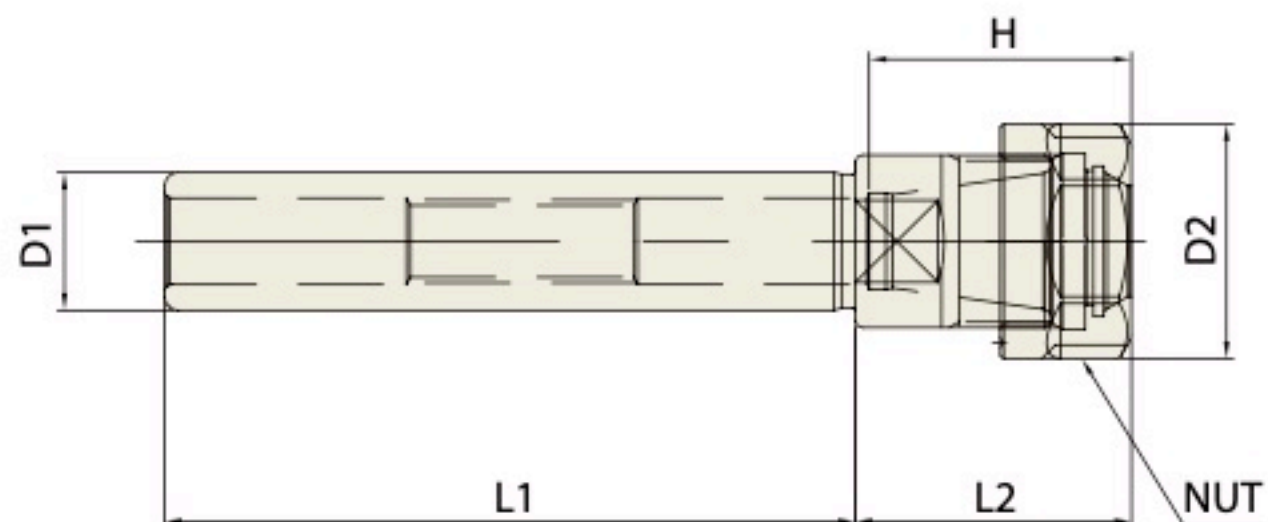

ER Collet
Refer to page 103-109



ER nut, Sealing disk and Spanner
Refer to page 110-115

Unit : mm

| TAPER No. | MODEL No. | EDP No. | CLAMPING RANGE | D1 | D2 | L1 | L2 | H | NUT / COLLET | WEIGHT (kg) |
|-----------|--------------|----------|----------------|----|----|-----|----|------|--------------|-------------|
| 16 | K16-ER11-100 | P2772201 | 0.5 - 7.0 | 16 | 19 | 100 | 32 | 27 | ER11 | 0.15 |
| | K16-ER16-100 | P2772219 | 0.5 - 10.0 | 16 | 28 | 100 | 36 | 32.6 | ER16 | 0.18 |
| 20 | K20-ER16-100 | P2772202 | 0.5 - 10.0 | 20 | 28 | 100 | 36 | 35.6 | ER16 | 0.25 |
| | K20-ER20-100 | P2772203 | 0.5 - 13.0 | 20 | 34 | 100 | 40 | 38 | ER20 | 0.29 |
| | K20-ER25-100 | P2772220 | 1.0 - 16.0 | 20 | 42 | 100 | 50 | 44 | ER25 | 0.35 |
| 25 | K25-ER20-100 | P2772221 | 0.5 - 13.0 | 25 | 34 | 100 | 40 | 71.6 | ER20 | 0.40 |
| | K25-ER25-100 | P2772204 | 1.0 - 16.0 | 25 | 42 | 100 | 50 | 43.1 | ER25 | 0.45 |
| 32 | K32-ER16-100 | P2772222 | 0.5 - 10.0 | 32 | 28 | 100 | 36 | - | ER16 | 0.50 |
| | K32-ER20-100 | P2772223 | 0.5 - 13.0 | 32 | 34 | 100 | 40 | 71.6 | ER20 | 0.66 |
| | K32-ER25-100 | P2772224 | 1.0 - 16.0 | 32 | 42 | 100 | 50 | 71.1 | ER25 | 0.75 |
| | K32-ER32-100 | P2772225 | 1.0 - 20.0 | 32 | 50 | 100 | 58 | 78 | ER32 | 1.00 |