

Round Dies for general use
Round Dies for general use Left Hand
Round Dies for higher demands
Round Dies for stainless steels
Round Dies undersized

Material	Tolerance	Chamfer	Thread	Special Features
HSS	ISO-6g	1,5 threads	right hand thread	
HSS	ISO-6g	1,5 threads	left hand thread	
HSSE	ISO-6g	1,5 threads	right hand thread	with spiral entry
HSSE	ISO-6g	2 threads	right hand thread	lapped with spiral entry
HSS	6e	1,75 threads	right hand thread	lapped with spiral entry

MF

MF	D	D1	H	D2	No.	€	No.	€	No.	€	No.	€	No.	€	D2 Tol. 6e
MF 2,5 x 0,35	2,5	16	5	2,44	121401001	15,22									
MF 2,6 x 0,35	2,6	16	5	2,54	121401002	15,22									
MF 3 x 0,35	3,0	20	5	2,94	121401003	12,42					121405001	35,42			
MF 3,5 x 0,35	3,5	20	5	3,44	121401004	12,42					121405002	43,86			
MF 4 x 0,35	4,0	20	5	3,94	121401005	12,42									
MF 4 x 0,5	4,0	20	5	3,93	121401006	12,42					121405003	24,98	121421001	86,85	3,84 mm
MF 4,5 x 0,5	4,5	20	5	4,43	121401007	12,42									
MF 5 x 0,5	5,0	20	5	4,93	121401008	12,42					121405004	24,98	121421002	86,85	4,83 mm
MF 5 x 0,75	5,0	20	7	4,91	121401010	12,42									
MF 5,5 x 0,5	5,5	20	5	5,43	121401009	12,42									
MF 6 x 0,5	6,0	20	5	5,93	121401011	12,42					121405005	24,98	121421003	71,81	5,83 mm
MF 6 x 0,75	6,0	20	7	5,90	121401012	10,74	121402001	16,37	121404001	15,11	121405006	24,98	121421004	66,80	5,81 mm
MF 7 x 0,5	7,0	25	9	6,93	121401013	13,47							121421005	88,50	6,83 mm
MF 7 x 0,75	7,0	25	9	6,90	121401014	13,47					121405007	30,85			
MF 8 x 0,5	8,0	25	9	7,93	121401015	13,47					121405008	30,85	121421006	116,24	7,82 mm
MF 8 x 0,75	8,0	25	9	7,90	121401016	11,26	121402002	19,65	121404002	19,94	121405009	30,85	121421007	83,51	7,80 mm
MF 8 x 1,0	8,0	25	9	7,83	121401017	11,26	121402003	19,65	121404003	19,94	121405010	30,85	121421008	63,46	7,78 mm
MF 9 x 0,5	9,0	25	9	8,93	121401018	16,95									
MF 9 x 0,75	9,0	25	9	8,90	121401019	16,95									
MF 9 x 1,0	9,0	25	9	8,88	121401020	16,95									
MF 10 x 0,5	10,0	30	11	9,93	121401021	16,95									
MF 10 x 0,75	10,0	30	11	9,90	121401022	16,95					121405011	37,99	121421009	115,24	9,79 mm
MF 10 x 1,0	10,0	30	11	9,88	121401023	12,95	121402004	24,56	121404004	22,56	121405012	37,99	121421010	71,15	9,77 mm
MF 10 x 1,25	10,0	30	11	9,86	121401024	12,95	121402005	24,56	121404005	22,56	121405013	37,99			
MF 11 x 1,0	11,0	30	11	10,88	121401025	19,47									
MF 11 x 1,25	11,0	30	11	10,86	121401026	19,47									
MF 12 x 0,5	12,0	38	10	11,93	121401027	19,47									
MF 12 x 0,75	12,0	38	10	11,90	121401028	19,47							121421011	119,57	11,78 mm
MF 12 x 1,0	12,0	38	10	11,88	121401029	16,53	121402006	31,93	121404006	39,04	121405014	46,28	121421012	93,52	11,76 mm
MF 12 x 1,25	12,0	38	10	11,86	121401030	16,53	121402007	31,93	121404007	39,04	121405015	46,28			
MF 12 x 1,5	12,0	38	10	11,85	121401031	16,00	121402008	31,93	121404008	39,04	121405016	46,28	121421013	87,84	11,73 mm
MF 13 x 0,5	13,0	38	10	12,93	121401032	27,16									
MF 13 x 1,0	13,0	38	10	12,88	121401033	21,79									

Round Dies for general use
Round Dies for general use Left Hand
Round Dies for higher demands
Round Dies for stainless steels
Round Dies undersized

Material	TOL	Chamfer	Thread	Special Features
HSS	ISO-6g	1,5 threads	right hand thread	
HSS	ISO-6g	1,5 threads	left hand thread	
HSSE	ISO-6g	1,5 threads	right hand thread	with spiral entry
HSSE	ISO-6g	2 threads	right hand thread	lapped with spiral entry
HSS	6e	1,75 threads	right hand thread	lapped with spiral entry

MF

MF	D	D1	H	D2	No.	€	No.	€	No.	€	No.	€	No.	€	D2 Tol. 6e
MF 13 x 1,5	13,0	38	10	12,85	121401034	21,79									
MF 14 x 0,5	14,0	38	10	13,93	121401035	27,16									
MF 14 x 0,75	14,0	38	10	13,90	121401036	21,79									
MF 14 x 1,0	14,0	38	10	13,88	121401037	21,79					121405017	46,81	121421014	101,87	13,76 mm
MF 14 x 1,25	14,0	38	10	13,86	121401038	18,21	121402009	31,93	121404009	39,04	121405018	46,81			
MF 14 x 1,5	14,0	38	10	13,85	121401039	18,21	121402010	31,93	121404010	39,04	121405019	46,81	121421015	87,84	13,73 mm
MF 15 x 0,75	15,0	38	10	14,90	121401040	34,32									
MF 15 x 1,0	15,0	38	10	14,88	121401041	29,58									
MF 15 x 1,5	15,0	38	10	14,85	121401042	29,58									
MF 16 x 0,5	16,0	45	14	15,93	121401043	37,89									
MF 16 x 0,75	16,0	45	14	15,90	121401044	37,89									
MF 16 x 1,0	16,0	45	14	15,88	121401045	29,58	121402011	47,94			121405020	68,32	121421016	136,94	15,76 mm
MF 16 x 1,25	16,0	45	14	15,86	121401046	29,58									
MF 16 x 1,5	16,0	45	14	15,85	121401047	23,26	121402012	47,94	121404011	61,71	121405021	68,32	121421017	118,90	15,73 mm
MF 17 x 1,0	17,0	45	14	16,88	121401048	40,21									
MF 17 x 1,5	17,0	45	14	16,85	121401049	40,21									
MF 18 x 0,5	18,0	45	14	17,93	121401050	40,21									
MF 18 x 0,75	18,0	45	14	17,90	121401051	40,21									
MF 18 x 1,0	18,0	45	14	17,88	121401052	27,16					121405022	68,85	121421018	203,74	17,74 mm
MF 18 x 1,25	18,0	45	14	17,86	121401053	27,16									
MF 18 x 1,5	18,0	45	14	17,85	121401054	23,26	121402013	47,94	121404012	61,71	121405023	68,85	121421019	118,90	17,71 mm
MF 18 x 2,0	18,0	45	14	17,82	121401055	27,79			121404013	61,71					
MF 19 x 1,0	19,0	45	14	18,88	121401056	40,21									
MF 19 x 1,5	19,0	45	14	18,85	121401057	27,16									
MF 20 x 0,5	20,0	45	14	19,93	121401058	40,21									
MF 20 x 0,75	20,0	45	14	19,90	121401059	40,21									
MF 20 x 1,0	20,0	45	14	19,88	121401060	27,79					121405024	70,52	121421020	203,74	19,66 mm
MF 20 x 1,25	20,0	45	14	19,86	121401061	27,79									
MF 20 x 1,5	20,0	45	14	19,85	121401062	23,26	121402014	47,94	121404014	61,71	121405025	70,52	121421021	136,94	19,71 mm
MF 20 x 2,0	20,0	45	14	19,82	121401063	27,79			121404015	61,71					
MF 21 x 1,0	21,0	45	14	20,88	121401064	42,00									
MF 21 x 1,5	21,0	45	14	20,85	121401065	42,00									
MF 22 x 0,5	22,0	55	16	21,93	121401066	58,00									

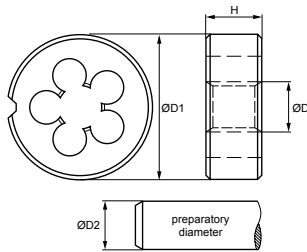

Round Dies for general use

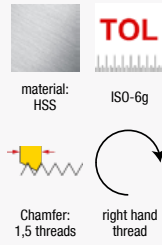

Round Dies for general use Left Hand

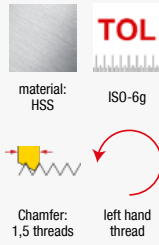

Round Dies for higher demands

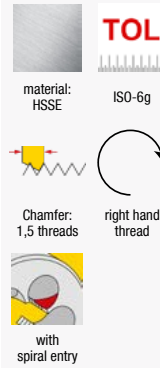

Round Dies for stainless steels

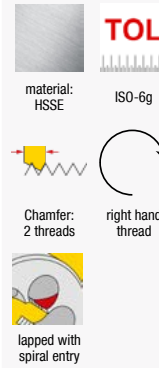

Round Dies undersized

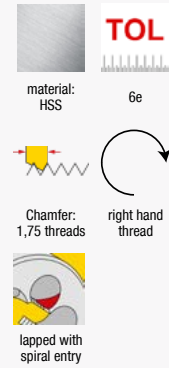

MF

	D	D1	H	D2	No.	€	No.	€	No.	€	No.	€	No.	€	D2 Tol. 6e
MF 22 x 0,75	22,0	55	16	21,90	121401067	58,00									
MF 22 x 1,0	22,0	55	16	21,88	121401068	44,95									
MF 22 x 1,25	22,0	55	16	21,86	121401069	44,95									
MF 22 x 1,5	22,0	55	16	21,85	121401070	40,53	121402015	76,02	121404016	108,31	121405026	104,74	121421022	170,34	21,71 mm
MF 22 x 2,0	22,0	55	16	21,82	121401071	44,95									
MF 23 x 1,0	23,0	55	16	22,88	121401072	58,95									
MF 23 x 1,5	23,0	55	16	22,85	121401073	44,95									
MF 24 x 0,5	24,0	55	16	23,93	121401074	58,00									
MF 24 x 0,75	24,0	55	16	23,90	121401075	58,00									
MF 24 x 1,0	24,0	55	16	23,88	121401076	44,95							121421023	283,91	21,74 mm
MF 24 x 1,25	24,0	55	16	23,86	121401077	44,95									
MF 24 x 1,5	24,0	55	16	23,85	121401078	40,53	121402016	76,02	121404017	108,31	121405027	115,76	121421024	220,45	23,70 mm
MF 24 x 2,0	24,0	55	16	22,82	121401079	44,95	121402017	76,02			121405028	115,76			
MF 25 x 1,0	25,0	55	16	24,88	121401080	58,00									
MF 25 x 1,5	25,0	55	16	24,85	121401081	58,00									
MF 26 x 1,0	26,0	55	16	25,88	121401082	58,00									
MF 26 x 1,5	26,0	55	16	25,85	121401083	58,00					121405029	195,30	121421025	250,50	25,69 mm
MF 26 x 2,0	26,0	55	16	25,82	121401084	58,00									
MF 27 x 1,0	27,0	65	18	26,88	121401085	66,32									
MF 27 x 1,5	27,0	65	18	26,85	121401086	66,32									
MF 27 x 2,0	27,0	65	18	26,82	121401087	66,32									
MF 28 x 1,0	28,0	65	18	27,88	121401088	66,32									
MF 28 x 1,5	28,0	65	18	27,85	121401089	66,32									
MF 28 x 2,0	28,0	65	18	27,82	121401090	66,32									
MF 29 x 1,5	29,0	65	18	28,85	121401091	66,32									
MF 30 x 1,0	30,0	65	18	29,88	121401092	66,32									
MF 30 x 1,5	30,0	65	18	29,85	121401093	66,32					121405030	215,15			
MF 30 x 2,0	30,0	65	18	29,82	121401094	66,32	121402018	120,46			121405031	225,45			
MF 30 x 2,5	30,0	65	18	29,79	121401095	66,32	121402019	120,46							
MF 30 x 3,0	30,0	65	25	29,76	121401096	66,32	121402020	120,46							
MF 32 x 1,0	32,0	65	18	31,88	121401098	93,68	121402021	120,46							
MF 32 x 1,5	32,0	65	18	31,85	121401097	66,32	121402022	120,46							
MF 32 x 2,0	32,0	65	18	31,82	121401099	66,32	121402023	120,46							

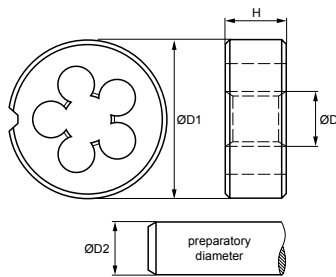
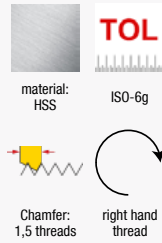
Round Dies for general use

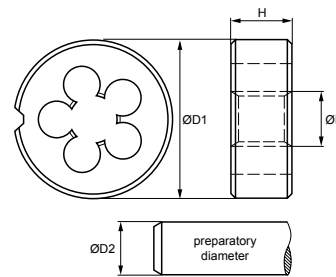
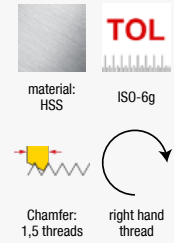

Round Dies for general use



MF

	D	D1	H	D2	No.	€
MF 32 x 3,0	32,0	65	25	31,77	121401100	66,32
MF 33 x 1,5	33,0	65	18	32,85	121401101	66,32
MF 33 x 2,0	33,0	65	18	32,82	121401102	66,32
MF 33 x 3,0	33,0	65	25	32,76	121401103	66,32
MF 34 x 1,0	34,0	65	18	33,88	121401104	93,68
MF 34 x 1,5	34,0	65	18	33,85	121401105	66,32
MF 34 x 2,0	34,0	65	18	33,82	121401106	66,32
MF 35 x 1,0	35,0	65	18	34,88	121401107	93,68
MF 35 x 1,5	35,0	65	18	34,85	121401108	66,32
MF 35 x 2,0	35,0	65	18	34,82	121401109	93,68
MF 36 x 1,0	36,0	65	18	35,88	121401110	93,68
MF 36 x 1,5	36,0	65	18	35,85	121401111	66,32
MF 36 x 2,0	36,0	65	18	35,82	121401112	66,32
MF 36 x 3,0	36,0	65	25	35,76	121401113	66,32
MF 37 x 1,5	37,0	65	18	36,85	121401114	141,05
MF 38 x 1,0	38,0	75	20	37,88	121401115	141,05
MF 38 x 1,5	38,0	75	20	37,85	121401116	107,37
MF 38 x 2,0	38,0	75	20	37,82	121401117	107,37
MF 38 x 3,0	38,0	75	30	37,77	121401118	141,05
MF 39 x 1,5	39,0	75	20	38,85	121401119	107,37
MF 39 x 2,0	39,0	75	20	38,82	121401120	107,37
MF 39 x 3,0	39,0	75	30	38,76	121401121	107,37
MF 40 x 1,0	40,0	75	20	39,88	121401122	141,05
MF 40 x 1,5	40,0	75	20	39,85	121401123	107,37
MF 40 x 2,0	40,0	75	20	39,82	121401124	107,37
MF 40 x 3,0	40,0	75	30	39,76	121401125	107,37
MF 42 x 1,0	42,0	75	20	41,88	121401126	141,05
MF 42 x 1,5	42,0	75	20	41,85	121401127	107,37
MF 42 x 2,0	42,0	75	20	41,82	121401128	107,37
MF 42 x 3,0	42,0	75	30	41,76	121401129	107,37
MF 44 x 1,5	44,0	90	22	43,85	121401130	231,58
MF 44 x 2,0	44,0	90	22	43,82	121401131	231,58
MF 45 x 1,0	45,0	90	22	44,88	121401132	231,58

MF

	D	D1	H	D2	No.	€
MF 45 x 1,5	45,0	90	22	44,85	121401133	178,95
MF 45 x 2,0	45,0	90	22	44,82	121401134	178,95
MF 45 x 3,0	45,0	90	36	44,76	121401135	178,95
MF 46 x 1,5	46,0	90	22	45,85	121401136	231,58
MF 48 x 1,0	48,0	90	22	47,88	121401137	231,58
MF 48 x 1,5	48,0	90	22	47,85	121401138	178,95
MF 48 x 2,0	48,0	90	22	47,82	121401139	178,95
MF 48 x 3,0	48,0	90	36	47,46	121401140	178,95
MF 50 x 1,5	50,0	90	22	49,85	121401141	178,95
MF 50 x 2,0	50,0	90	22	49,82	121401142	178,95
MF 50 x 3,0	50,0	90	36	49,76	121401143	178,95
MF 52 x 1,5	52,0	90	22	51,85	121401144	178,95
MF 52 x 2,0	52,0	90	22	51,82	121401145	178,95
MF 52 x 3,0	52,0	90	36	51,76	121401146	178,95
MF 54 x 1,5	54,0	105	22	53,92	121401147	353,68
MF 54 x 2,0	54,0	105	22	53,91	121401148	353,68
MF 54 x 3,0	54,0	105	36	53,88	121401149	353,68
MF 54 x 4,0	54,0	105	36	53,85	121401150	353,68
MF 55 x 1,5	55,0	105	22	54,85	121401151	353,68
MF 55 x 2,0	55,0	105	22	54,82	121401152	353,68
MF 55 x 3,0	55,0	105	36	54,76	121401153	353,68
MF 55 x 4,0	55,0	105	36	54,73	121401154	353,68
MF 56 x 1,5	56,0	105	22	55,85	121401155	353,68
MF 56 x 2,0	56,0	105	22	55,82	121401156	353,68
MF 56 x 3,0	56,0	105	36	55,76	121401157	353,68
MF 56 x 4,0	56,0	105	36	55,73	121401158	353,68
MF 58 x 1,5	58,0	105	22	57,92	121401159	353,68
MF 58 x 2,0	58,0	105	22	57,91	121401160	353,68
MF 58 x 3,0	58,0	105	36	57,88	121401161	353,68
MF 58 x 4,0	58,0	105	36	57,85	121401162	353,68
MF 60 x 1,5	60,0	105	22	59,92	121401163	353,68
MF 60 x 2,0	60,0	105	22	59,91	121401164	353,68
MF 60 x 3,0	60,0	105	36	59,88	121401165	353,68

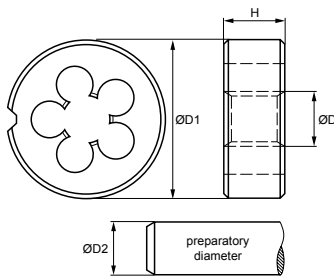
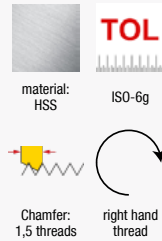
Round Dies for general use



Round Dies for general use

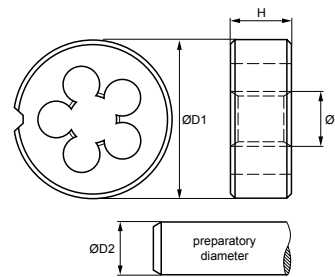
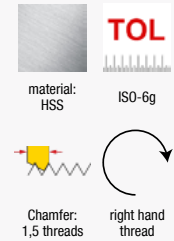

MF

	D	D1	H	D2	No.	€
MF 60 x 4,0	60,0	105	36	59,85	121401166	353,68
MF 62 x 1,5	62,0	105	22	61,92	121401167	353,68
MF 62 x 2,0	62,0	105	22	61,91	121401168	353,68
MF 62 x 3,0	62,0	105	36	61,88	121401169	353,68
MF 62 x 4,0	62,0	105	36	61,85	121401170	353,68
MF 63 x 1,5	63,0	105	22	62,92	121401171	353,68
MF 64 x 1,5	64,0	120	22	63,92	121401172	402,11
MF 64 x 2,0	64,0	120	22	63,91	121401173	402,11
MF 64 x 3,0	64,0	120	36	63,88	121401174	402,11
MF 64 x 4,0	64,0	120	36	63,85	121401175	402,11
MF 65 x 1,5	65,0	120	22	64,92	121401176	402,11
MF 65 x 2,0	65,0	120	22	64,91	121401177	402,11
MF 65 x 3,0	65,0	120	36	64,88	121401178	402,11
MF 65 x 4,0	65,0	120	36	64,85	121401179	402,11
MF 68 x 1,5	68,0	120	22	67,92	121401180	402,11
MF 68 x 2,0	68,0	120	22	67,91	121401181	402,11
MF 68 x 3,0	68,0	120	36	67,88	121401182	402,11
MF 68 x 4,0	68,0	120	36	67,85	121401183	402,11
MF 70 x 1,5	70,0	120	22	69,92	121401184	402,11
MF 70 x 2,0	70,0	120	22	69,91	121401185	402,11
MF 70 x 3,0	70,0	120	36	69,88	121401186	402,11
MF 70 x 4,0	70,0	120	36	69,85	121401187	402,11
MF 72 x 1,5	72,0	120	22	71,92	121401188	402,11
MF 72 x 2,0	72,0	120	22	71,91	121401189	402,11
MF 72 x 3,0	72,0	120	36	71,88	121401190	402,11
MF 72 x 4,0	72,0	120	36	71,85	121401191	402,11
MF 74 x 1,5	74,0	120	22	73,92	121401192	402,11
MF 74 x 2,0	74,0	120	22	73,91	121401193	402,11
MF 74 x 3,0	74,0	120	36	73,88	121401194	402,11
MF 74 x 4,0	74,0	120	36	73,85	121401195	402,11
MF 75 x 1,5	75,0	120	22	74,92	121401196	402,11
MF 75 x 2,0	75,0	120	22	74,91	121401197	402,11
MF 75 x 3,0	75,0	120	36	74,88	121401198	402,11

MF

	D	D1	H	D2	No.	€
MF 75 x 4,0	75,0	120	36	74,85	121401199	402,11
MF 76 x 1,5	76,0	120	22	75,92	121401200	402,11
MF 76 x 2,0	76,0	120	22	75,91	121401201	402,11
MF 76 x 3,0	76,0	120	36	75,88	121401202	402,11
MF 76 x 4,0	76,0	120	36	75,85	121401203	402,11
MF 78 x 1,5	78,0	120	22	77,92	121401204	402,11
MF 78 x 2,0	78,0	120	22	77,91	121401205	402,11
MF 78 x 3,0	78,0	120	36	77,88	121401206	402,11
MF 78 x 4,0	78,0	120	36	77,85	121401207	402,11
MF 80 x 1,5	80,0	120	22	79,92	121401208	402,11
MF 80 x 2,0	80,0	120	22	79,91	121401209	402,11
MF 80 x 3,0	80,0	120	36	79,88	121401210	402,11
MF 80 x 4,0	80,0	120	36	79,85	121401211	402,11
MF 82 x 1,5	82,0	130	25	81,92	121401212	508,42
MF 82 x 2,0	82,0	130	25	81,91	121401213	508,42
MF 82 x 3,0	82,0	130	36	81,88	121401214	508,42
MF 82 x 4,0	82,0	130	36	81,85	121401215	508,42
MF 84 x 1,5	84,0	130	25	83,92	121401216	508,42
MF 84 x 2,0	84,0	130	25	83,91	121401217	508,42
MF 84 x 3,0	84,0	130	36	83,88	121401218	508,42
MF 84 x 4,0	84,0	130	36	83,85	121401219	508,42
MF 85 x 1,5	85,0	130	25	84,92	121401220	508,42
MF 85 x 2,0	85,0	130	25	84,91	121401221	508,42
MF 85 x 3,0	85,0	130	36	84,88	121401222	508,42
MF 85 x 4,0	85,0	130	36	84,85	121401223	508,42
MF 86 x 1,5	86,0	140	22	85,92	121401224	633,68
MF 86 x 2,0	86,0	140	22	85,91	121401225	633,68
MF 86 x 3,0	86,0	140	22	85,88	121401226	633,68
MF 86 x 4,0	86,0	140	22	85,85	121401227	633,68
MF 88 x 1,5	88,0	140	22	87,92	121401228	633,68
MF 88 x 2,0	88,0	140	22	87,91	121401229	633,68
MF 88 x 3,0	88,0	140	22	87,88	121401230	633,68
MF 88 x 4,0	88,0	140	22	87,85	121401231	633,68

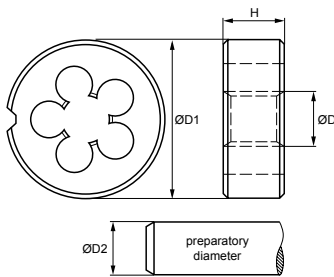
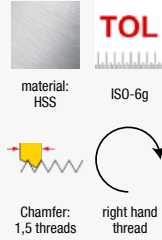
Round Dies for general use

MF

	D	D1	H	D2	No.	€
MF 90 x 1,5	90,0	140	22	89,92	121401232	633,68
MF 90 x 2,0	90,0	140	22	89,91	121401233	633,68
MF 90 x 3,0	90,0	140	22	89,88	121401234	633,68
MF 90 x 4,0	90,0	140	22	89,85	121401235	633,68
MF 92 x 1,5	92,0	140	22	91,92	121401236	633,68
MF 92 x 2,0	92,0	140	22	91,91	121401237	633,68
MF 92 x 3,0	92,0	140	22	91,88	121401238	633,68
MF 92 x 4,0	92,0	140	22	91,85	121401239	633,68
MF 95 x 1,5	95,0	140	22	94,92	121401240	633,68
MF 95 x 2,0	95,0	140	22	94,91	121401241	633,68
MF 95 x 3,0	95,0	140	22	94,88	121401242	633,68
MF 95 x 4,0	95,0	140	22	94,85	121401243	633,68
MF 96 x 1,5	96,0	140	22	95,92	121401244	633,68
MF 96 x 2,0	96,0	140	22	95,91	121401245	633,68
MF 96 x 3,0	96,0	140	22	95,88	121401246	633,68
MF 96 x 4,0	96,0	140	22	95,85	121401247	633,68
MF 98 x 1,5	98,0	150	25	94,92	121401248	762,11
MF 98 x 2,0	98,0	150	25	97,91	121401249	762,11
MF 98 x 3,0	98,0	150	25	97,88	121401250	762,11
MF 98 x 4,0	98,0	150	25	97,85	121401251	762,11
MF 100 x 1,5	100,0	150	25	99,92	121401252	762,11
MF 100 x 2,0	100,0	150	25	99,91	121401253	762,11
MF 100 x 3,0	100,0	150	25	99,88	121401254	762,11
MF 100 x 4,0	100,0	150	25	99,85	121401255	762,11
MF 105 x 1,5	105,0	150	25	104,92	121401256	762,11
MF 105 x 2,0	105,0	150	25	104,91	121401257	762,11
MF 105 x 3,0	105,0	150	25	104,88	121401258	762,11
MF 105 x 4,0	105,0	150	25	104,85	121401259	762,11
MF 110 x 1,5	110,0	160	25	109,92	121401260	832,63
MF 110 x 2,0	110,0	160	25	109,91	121401261	832,63
MF 110 x 3,0	110,0	160	25	109,88	121401262	832,63
MF 110 x 4,0	110,0	160	25	109,85	121401263	832,63