

# Clamping Studs



HRC 27°

Heat Treated Steel

Studs

Black Oxide Finished

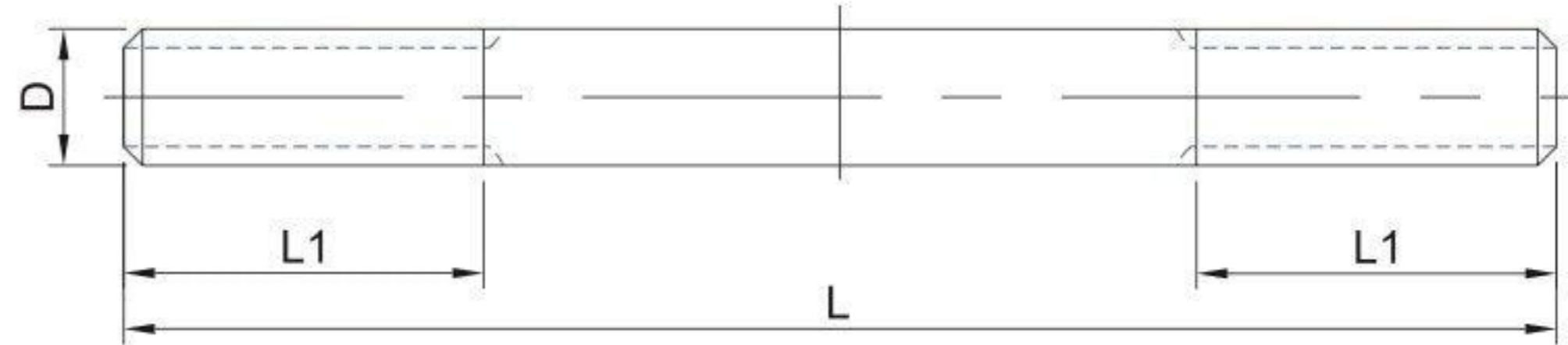

Metric Size

ORDER NO.	D	L	L1	WEIGHT (kgs)	CODE NO.
1323M	M8x1.25P	75	30	0.023	1003-071
1324M		100	40	0.03	1003-072
1325M		125	40	0.04	1003-073
1326M		150	40	0.05	1003-074
1327M		175	40	0.06	1003-075
1328M		200	40	0.07	1003-076
1333M	M10x1.5P	75	30	0.04	1003-081
1334M		100	40	0.05	1003-082
1335M		125	40	0.06	1003-083
1336M		150	40	0.07	1003-084
1337M		175	40	0.09	1003-085
1338M		200	40	0.10	1003-086
1343M	M12x1.75P	75	30	0.06	1003-091
1344M		100	40	0.07	1003-092
1345M		125	40	0.09	1003-093
1346M		150	40	0.11	1003-094
1347M		175	40	0.13	1003-095
1348M		200	40	0.15	1003-096
1343MA	M14x2.0P	75	30	0.07	1003-101
1344MA		100	40	0.10	1003-102
1345MA		125	40	0.13	1003-103
1346MA		150	40	0.15	1003-104
1347MA		175	40	0.18	1003-105
1348MA		200	40	0.20	1003-106
1353M	M16x2.0P	75	30	0.09	1003-111
1354M		100	45	0.13	1003-112
1355M		125	45	0.16	1003-113
1356M		150	45	0.19	1003-114
1357M		175	45	0.23	1003-115
1358M		200	45	0.25	1003-116
13510M		250	45	0.31	1003-117
13512M		300	45	0.38	1003-118
1363M	M18x2.5P	75	30	0.12	1003-120
1364M		100	40	0.16	1003-121
1365M		125	45	0.20	1003-122
1366M		150	45	0.25	1003-123
1367M		175	45	0.30	1003-124
1368M		200	45	0.32	1003-125
13610M		250	50	0.40	1003-126
13612M		300	50	0.50	1003-127
1373M	M20x2.5P	75	30	0.15	1003-140
1374M		100	40	0.20	1003-141
1375M		125	45	0.25	1003-142
1376M		150	45	0.30	1003-143
1377M		175	45	0.35	1003-144
1378M		200	45	0.40	1003-145
13710M		250	50	0.50	1003-146
13712M		300	50	0.65	1003-147
1384M	M24x3.0P	100	40	0.25	1003-150
1385M		125	45	0.35	1003-151
1386M		150	45	0.45	1003-152
1387M		175	45	0.53	1003-153
1388M		200	45	0.60	1003-154

OPERATING TORQUE FOR

TUNT. FLANGE NUT. SCREW	
SCREW SIZE	TORQUE(NM)
M3	1.1
M4	2.4
M5	4.8
M6	8.4
M8	21
M10	42
M12	72
M16	180
M20	352
M24	564

Inch Size

ORDER NO.	D	L	L1	WEIGHT (kgs)	CODE NO.
1333I	3/18-16	3"	30	0.04	1003-081I
1334I		4"	40	0.05	1003-082I
1335I		5"	40	0.06	1003-083I
1336I		6"	40	0.07	1003-084I
1337I		7"	40	0.09	1003-085I
1338I		8"	40	0.10	1003-086I
1343I	1/2-12 1/2-13	3"	30	0.06	1003-091I
1344I		4"	40	0.07	1003-092I
1345I		5"	40	0.09	1003-093I
1346I		6"	40	0.11	1003-094I
1347I		7"	40	0.13	1003-095I
1348I		8"	40	0.15	1003-096I
1353I	5/8-11	3"	30	0.09	1003-111I
1354I		4"	40	0.13	1003-112I
1355I		5"	40	0.16	1003-113I
1356I		6"	40	0.19	1003-114I
1357I		7"	40	0.23	1003-115I
1358I		8"	40	0.25	1003-116I
13510I		10"	45	0.31	1003-117I
13512I		12"	45	0.38	1003-118I
1363I	3/4-10	3"	30	0.12	1003-120I
1364I		4"	40	0.16	1003-121I
1365I		5"	45	0.20	1003-122I
1366I		6"	45	0.25	1003-123I
1367I		7"	45	0.30	1003-124I
1368I		8"	45	0.32	1003-125I
13610I		10"	50	0.40	1003-126I
13612I		12"	50	0.50	1003-127I
13614I	14"	50	0.62	1003-128I	
13616I	16"	50	0.75	1003-129I	
13618I	18"	50	0.87	1003-130I	
13620I	20"	50	1.00	1003-131I	
1373I	7/8-9	3"	30	0.183	1003-140I
1374I		4"	45	0.25	1003-141I
1375I		5"	45	0.30	1003-142I
1376I		6"	45	0.40	1003-143I
1377I		7"	45	0.45	1003-144I
1378I		8"	45	0.50	1003-145I
1384I	1"-8	4"	45	0.25	1003-150I
1385I		5"	45	0.35	1003-151I
1386I		6"	45	0.45	1003-152I
1387I		7"	45	0.53	1003-153I
1388I		8"	45	0.60	1003-154I