

RC (BSPT)

Whitworth tapered pipe thread / DIN 2999

RP (BSPP)

British standard whitworth pipe thread / ISO 7-1

Efficient internal thread cutting.

The short structural type makes that tap usable by machine and hand.

Application:

- ⚙ non abrasive material up to 900 N/mm²
- ⚙ unalloyed and low alloyed steel

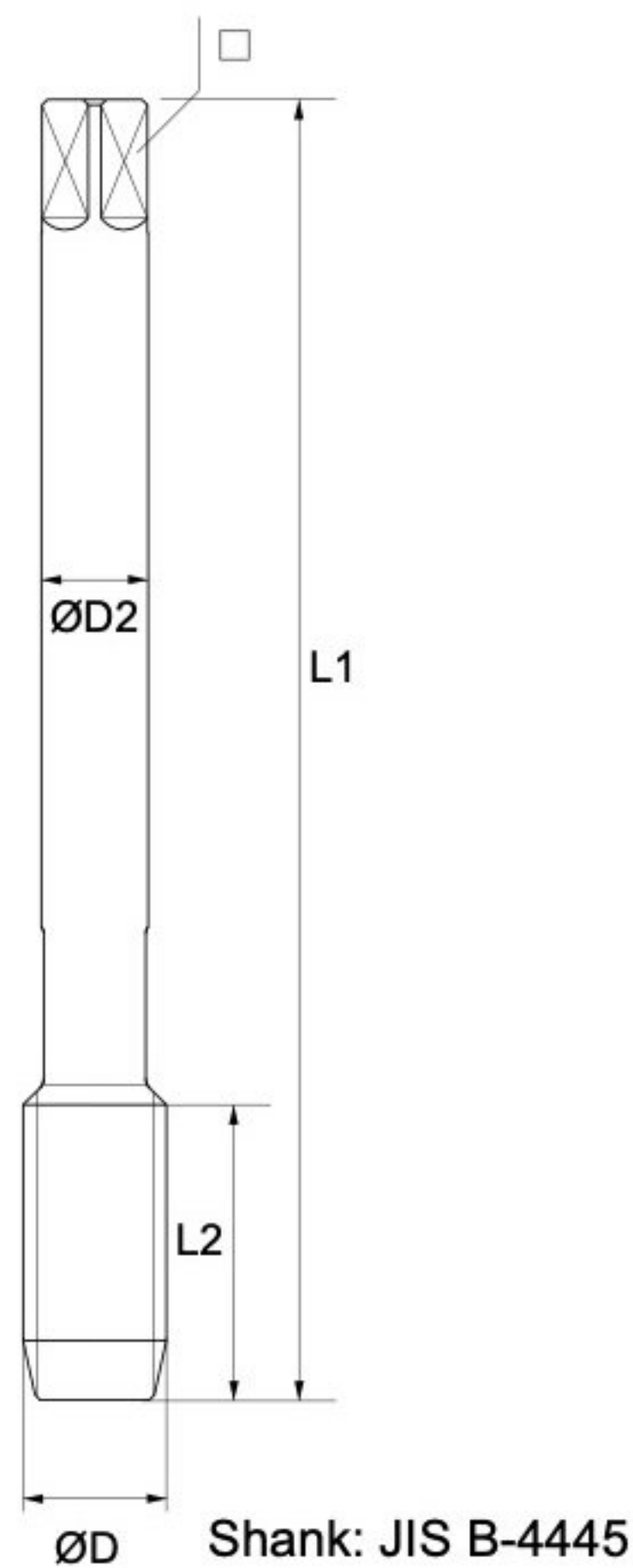

Short Machine Taps

Form C for through holes and blind holes

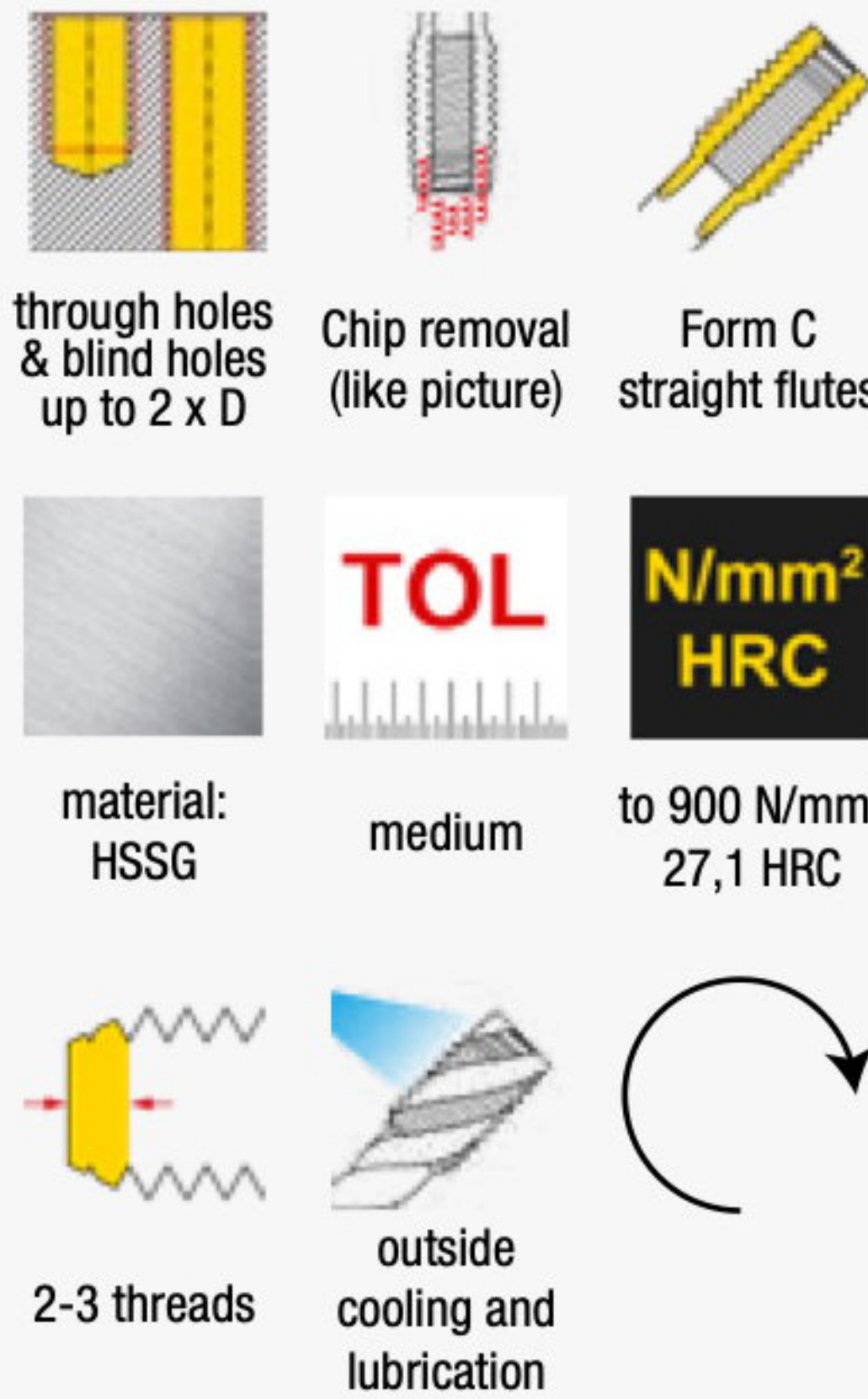

Hexagon Die Nuts

for general use

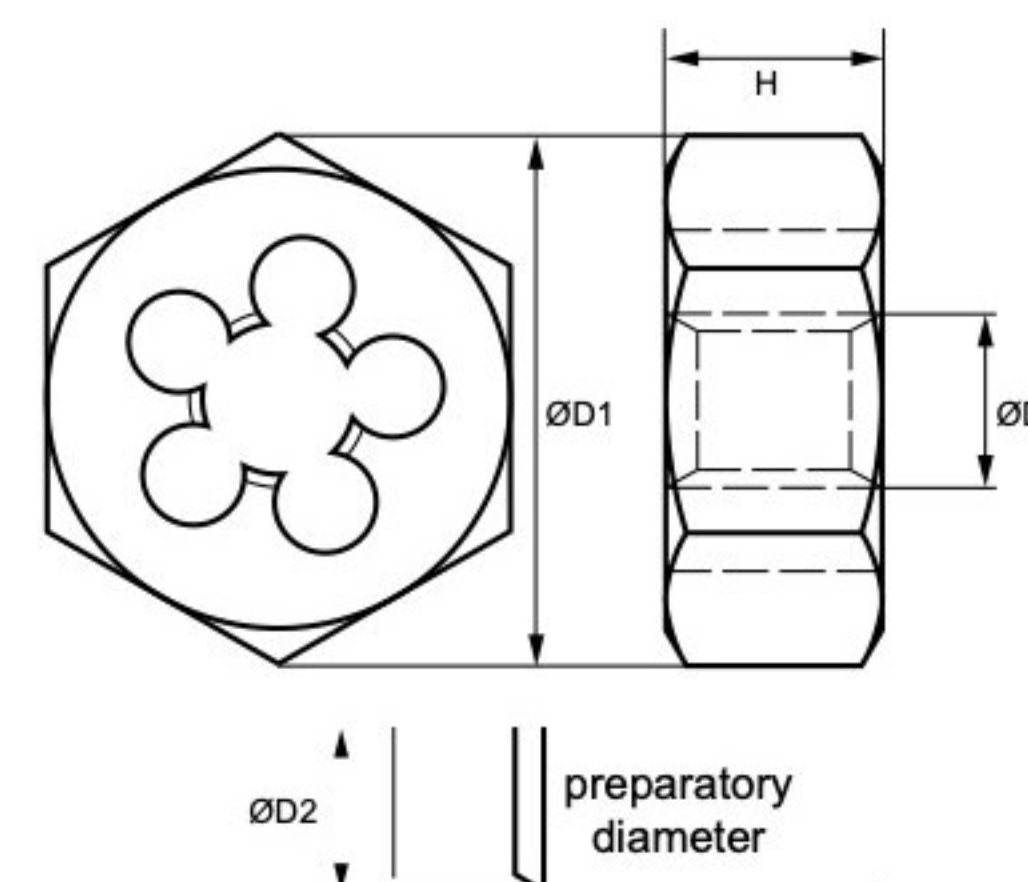
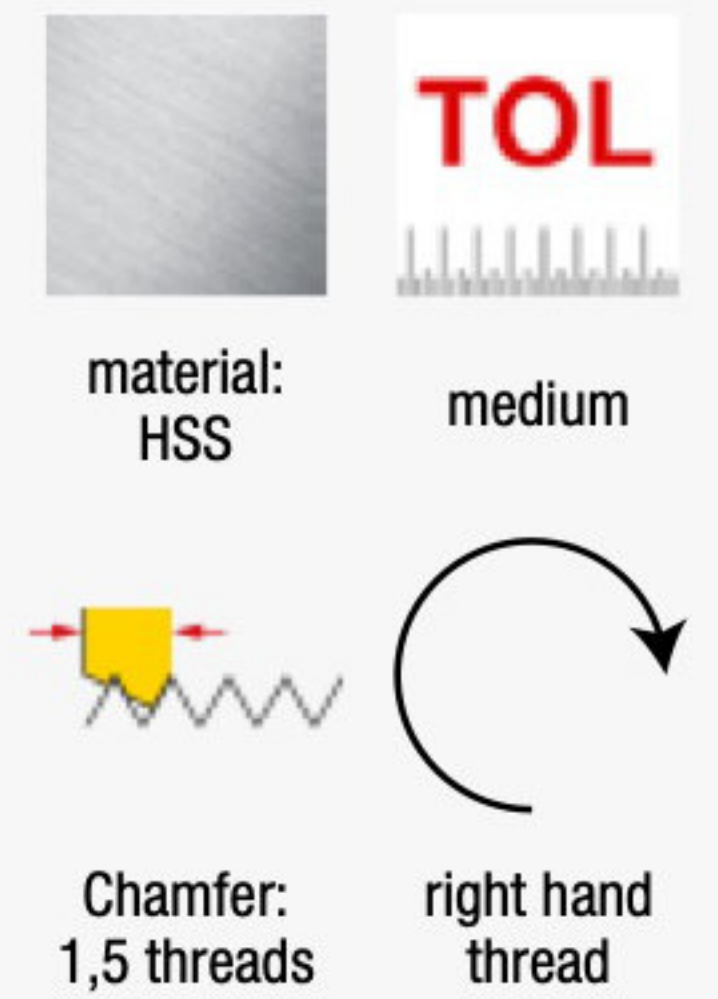

RC (BSPT)

	D1	D2	L1	L2	□	⚙	No.
RC 1/16 x 28	7,72	8,0	55	17,5	6,0	6,30	
RC 1/8 x 28	9,73	8,0	55	19	6,0	8,30	270101001
RC 1/4 x 19	13,16	11,0	62	28	9,0	11,10	270101002
RC 3/8 x 19	16,66	14,0	65	28	11,0	14,50	270101003
RC 1/2 x 14	20,95	18,0	80	35	14,0	18,10	270101004
RC 3/4 x 14	26,44	23,0	85	35	17,0	23,50	270101005
RC 1" x 11	33,25	26,0	95	45	21,0	29,50	270101006
RC 1.1/4 x 11	41,91	32,0	105	45	26,0	38,25	
RC 1.1/2 x 11	47,80	38,0	110	45	29,0	44,25	
RC 2" x 11	59,61	46,0	120	50	35,0	56,00	

R (BSPT)

	D	D1	H	No.
R 1/8 x 28	9,73	27	11	271501001
R 1/4 x 19	13,16	36	14	271501002
R 3/8 x 19	16,66	41	15	271501003
R 1/2 x 14	20,95	50	19	271501004
R 3/4 x 14	26,44	60	20	271501005
R 1" x 11	33,25	60	25	271501006
R 1.1/4 x 11	41,91	85	26	271501007
R 1.1/2 x 11	47,80	85	26	271501008
R 2" x 11	59,61	100	31	271501009

RP (BSPP)

	D1	D2	L1	L2	□	⚙	No.
RP 1/16 x 28	7,72	8,0	55	18	6,0	6,55	280101001
RP 1/8 x 28	9,73	8,0	55	19	6,0	8,60	280101002
RP 1/4 x 19	13,16	11,0	62	28	9,0	11,50	280101003
RP 3/8 x 19	16,66	14,0	65	28	11,0	15,00	280101004
RP 1/2 x 14	20,95	18,0	80	35	14,0	18,50	280101005
RP 3/4 x 14	26,44	23,0	85	35	17,0	24,00	280101006
RP 1" x 11	33,25	26,0	95	45	21,0	30,25	280101007
RP 1.1/4 x 11	41,91	32,0	105	45	26,0	38,75	280101008
RP 1.1/2 x 11	47,80	38,0	110	45	29,0	44,75	280101009
RP 2" x 11	59,61	46,0	120	50	35,0	56,50	280101010